

# General Mounting Instructions

The fixture is designed for mounting under wall cap or step material only. A 1-3/8" (3.5 cm) reveal is required. Space fixtures 6' to 8' apart.

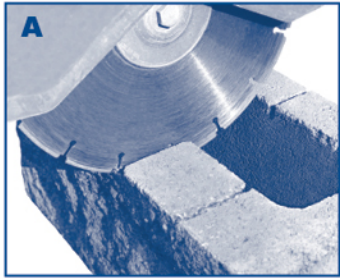

With a hammer, chip out a small crevice at bond lines for cable clearance. Route the cable through. A custom cable path can be created by saw cutting a 3/8" (9.5 mm) deep kerf in the block with a masonry saw (Photo A).

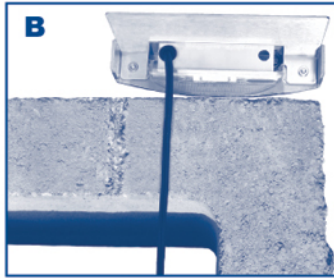

For easier mounting on corner blocks, the wire harness may be re-positioned by removing the wire harness and bushing, and installing them into the second hole (Photo B).



Install the fixture to the block and check for adequate clearance. Apply a small amount of adhesive to the underside of the fixture and set in place. Finish by placing cap material on top (Photo C).

## WIRING WITH THE OPTIONAL POWER TAP CONNECTOR™

**NOTE:** Use only with 12/2 or 10/3 circuit cable.

1. Turn the power unit on.

**NOTE:** It is highly recommended to install fixtures while the power unit is turned on.

2. Insert the end of the wire harness into the small rectangular hole on the base of the connector (1). Bend the wire over, pressing it firmly into the small groove. The wire will exit out only one side of the tap connector.

3. Place the supply cable in the large groove, pressing it firmly into place. Carefully align the top section over the bottom section, pressing the two halves together.

**NOTE:** The prongs must pierce the exact center of each cable (2). Each fixture will light as the prongs pierce the supply cable

4. Re-install the screw. Do not over tighten the screw or use pliers.

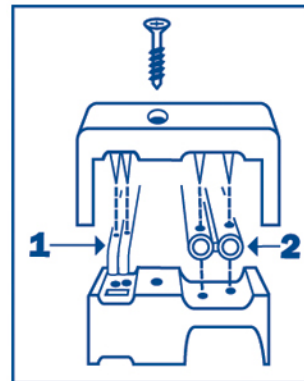

## REPLACEMENT OF THE LAMP MODULE

It is not necessary to remove the faceplate. However, the installation will be easier with it removed. Using your thumbs, press outwards on the metal tabs and pull the lamp down. Remove the wire harness from the lamp by gently twisting and pulling apart. To reinstall, hook the lamp onto the back bracket and push upwards from the center. The lamp will lock in place with a click.